

1 mm/0.8 mm DC - 110 GHz, Coaxial Adapters, Between-Series

DESCRIPTION

"KPC100F080F, KPC100F080M, KPC100M080F, and KPC100M080M"

coaxial adapters between 1.00 mm and 0.80 mm are small size, low SWR, and low loss.

They are designed for broadband measurement, instrument, and system applications.

SPECIFICATIONS

Electrical:

Frequency Range	DC - 110 GHz
SWR	< 2.0 ⁽¹⁾
Insertion Loss	1.4 dB (typ.) ⁽¹⁾
Electrical Length	8.7 mm (Nominal)
Temperature Range	-55 to +125 °C

Mechanical:

Body and Outer Conductor	Gold Plated Stainless Steel
Inner Conductor	Gold Plated Beryllium Copper and Brass
Coupling Torque	45 N-cm (Nominal)
Connect/Disconnect Life	> 500 Cycles (Estimate)



TYPE: KPC100F080F 1 mm Female/0.8 mm Female

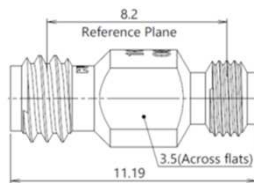

TYPE: KPC100F080M 1 mm Female/0.8 mm Male

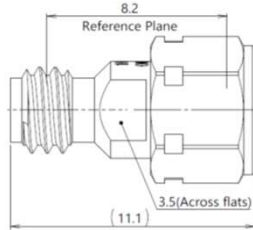

TYPE: KPC100M080F 1 mm Male/0.8 mm Female

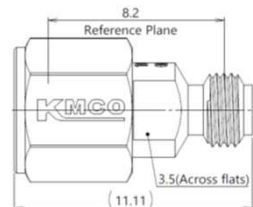

TYPE: KPC100M080M 1 mm Male/0.8 mm Male

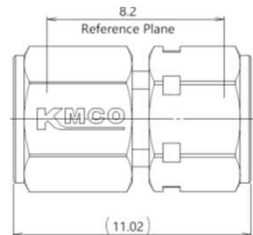

Performance test configuration

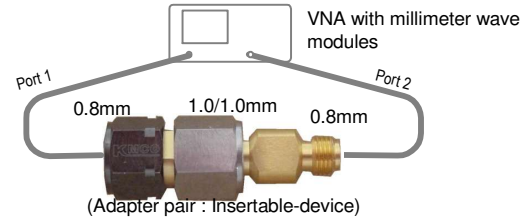

Typical Performance

(Number of adapter-pair samples: 3 pcs) KPC100F080F + KPC100M080M

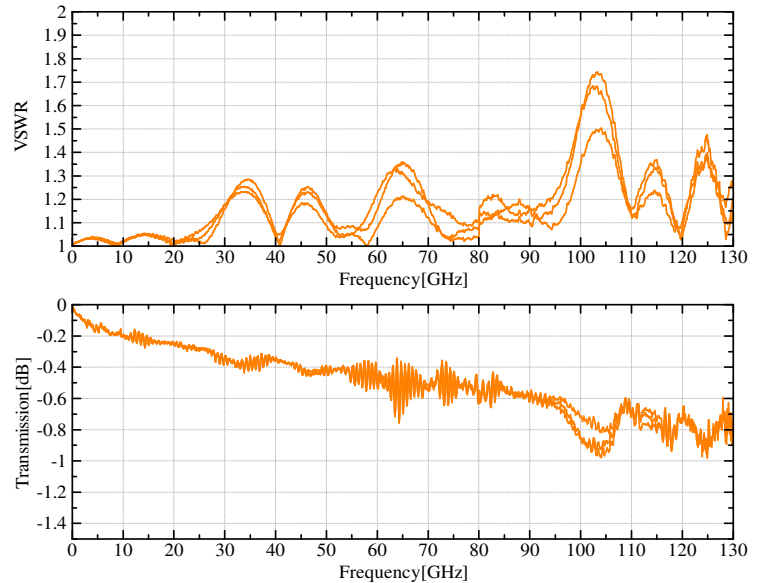

RoHS Compliant

REACH Compliant

Interface Mating Dimensions

KPC100 (1 mm Connectors)

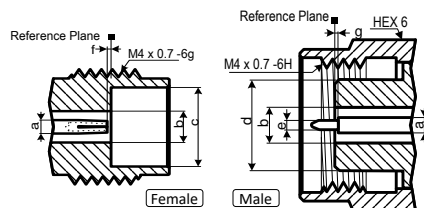

KPC100(1 mm)	
a	φ 0.434
b	φ 1.000
c	φ 2.390
d	φ 2.358
e	φ 0.250
f	0-0.013
g	0-0.013

KPC080 (0.8 mm Connectors)

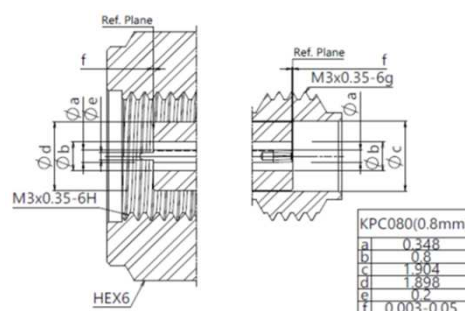

KPC080(0.8mm)	
a	0.348
b	0.8
c	1.904
d	1.898
e	0.2
f	0.003-0.05

NOTE:

All dimensions are in millimeters.

(1) 0.8 mm ports were measured for the measurement of return and insertion loss of the adapters with 1 mm ports mated as an interface, so these are shown as 2 adapters combined values.

Specifications Subject to Change Without Notice

Copyright(C) 2002-2024 Kawashima Manufacturing Co., Ltd. <All rights reserved.>

Rev. 01 Jun. 2024



Kawashima Manufacturing Co., Ltd.

1-3-5 Higashi-ikuta, Tama-ku,
Kawasaki 214-0031 JAPAN

TEL: +81-44-911-7073
https://kmco.co.jp/en/

FAX: +81-44-911-9621
e-mail: sales@kmco.co.jp